



**We Are  
Trikul International**

**Let's us show you  
what we do**

☎ **+91- 7366023923,8929854179**

✉ **enquiry@trikulinternational.com**  
**marketing@trikulinternational.com**

📍 **3rd Floor, Main Road Gijhore, Front of  
Manas Hospital, Sec-53 Noida,  
G.B. Nagar, U.P.-201301**

Trikul International Pvt.Ltd.  
WhatsApp business account



🌐 **www.trikulinternational.com**

We manufacture  
**FIRE RATED DOORS**

**WE ARE APPROVED BY**

**FIRE RESISTANCE TEST REPORT SCHEDULED-1/2**  
REFERENCE NO. FSE-CSIR-CBRI0113

*Disclaimer: The contents of this report are the privileged and confidential material of CSIR Central Building Research Institute, Roorkee. Information contained herein is solely intended for use by the client. Technical data provided in the report pertains to the representative sample of client submitted to the Institute and tested. CSIR-CBRI's name or logo cannot be used for commercial purposes. All procedural, legal, and/or operational matters will be the responsibility of the client using this report. Accepting/rejecting the results partly or fully rests with the concerned agencies.*

1. Name of the Testing Laboratory	Fire Safety Engineering CSIR-Central Building Research Institute, Roorkee-247667, Uttarakhand, India
2. Name of the Sponsor	M/s. Trikul International Pvt. Ltd., 3rd Floor, Main Road Gijhore, Front of Manas Hospital, Sec-53 Noida, G.B. Nagar, U.P.-201301
3. Sample Manufacturer	M/s. Trikul International Pvt. Ltd., 3rd Floor Main Road Gijhore, Front of Manas Hospital, Sec-53 Noida, G.B. Nagar, U.P.-201301
4. Manufacturer Consent for Fire Test of Sample	Yes
5. Sample Fire Tested for the Project	Not Applicable
6. Type of Test Sample	Door
7. Surface of Test Sample	Uncoated
8. Symmetry of Sample	Symmetrical
9. Details of Sample	Single leaf single swing metal composite fire door with vision panel
10. Dimension of Sample	Size Door Frame Door Panel Height : 2200mm 2450 mm Width : 1190mm 1124 mm Thickness: 100mm 50 mm
11. Sample in-fill materials	Proprietary insulation materials.
12. Sample Vision Panels	Make and thickness not mention.
13. Sample Hardware	Door Closer (Make: Trikul Tc555) S.S Ball Bearing Hinges (Make: Trikul ), Three point panic bar with external trim operated from both side (Make: Trikul).

**CSIR-CENTRAL BUILDING RESEARCH INSTITUTE**  
Roorkee - 247 667 (Uttarakhand), India

Dr. Harpal Singh  
Chief Scientist & Head

1/8

**CBRI ROORKEE**

**AJEO Testing Lab And Consultancy LLP**  
(An ISO Certified Laboratory) PUNJAB, INDIA  
Test Report Sample ID: L2/A2386210005-0001

**INDEX** This Certificate is Valid Only For Invoice No. 13183089101

1. PRODUCT DETAILS	A	PAGE 3
2. TEST METHOD & SPECIFICATION	B	PAGE 6
3. CRITERIA OF ACCEPTANCE INSULATION & INTEGRITY	C	PAGE 6
4. TEST SUMMARY FURNACE DETAILS & WALL DETAILS	D	PAGE 7
5. RESULTS & DISCUSSIONS RESULTS OF INTEGRITY TEST & INSULATION	E	PAGE 12
6. PHOTOGRAPHS	F	PAGE 14
7. CONCLUSION	G	PAGE 15

Address: I-3 - 51/1/54 Industrial Area, Sakshikand, Ghaziabad, Uttar Pradesh - 201005  
E-3 - 13A/06, Site-41, Industrial Area, Lod Road, Mahanagar, Ghaziabad, Uttar Pradesh - 201007  
ajeo@ajeo.in www.ajeo.in Contact No. : +91926961

Page 2 of 15

**AJEO EAST DELHI**

**TEST REPORT** Page 2 of 21  
Report No. 02200402422006024-11

Discipline: Mechanical  
Group: Building Materials

**TEST REPORT FIRE RESISTANCE TEST OF CONSTRUCTION ASSEMBLIES**

Test Assembly:  
Metal Fire Rated Door Double Leaf with Vision Panel

Test Standards:  
IS 476-2018B2\*, Fire tests on building materials and structures - Part 20: Method for determination of the fire resistance of elements of construction (general principles).  
\*Accordinging Amendment No. 2  
IS 476-2018B2, Fire test on building materials and structures - Part 22: Methods for determination of the fire resistance of non-loadbearing elements of construction.

ULR-TCB1422000011664F

Approved by: [Signature]  
Authorised Signatory

1/8

**SPECTRO  
GREATER NOIDA**

**WE MANUFACTURE LOCALLY**



Ministry of Micro, Small and Medium Enterprises,  
Government of India



MAKE IN INDIA

## 1. FIRE RATED DOOR'S

- \* Metal Fire Door
- \* Wooden Fire Door
- \* Glazed Fire Door
- \* Stainless Steel Fire Door
- \* Acoustic Fire Door (Metal/Wooden)
- \* Lead Line Door
- \* Fire Rated Window
- \* Fire Rated Glazed Partition
- \* Swing Door (Metal/Wooden/Stainless Steel)

## 2. Fire Rated Glass (Schott/SaintGobin/ FireView/ AIS)

- \* 6mm, 11mm, 12mm, 13mm, 14mm, 18mm

## 3. Fire Rated Hardware

- \* Push/Panic Bar
- \* External Trim
- \* Door Closer
- \* D/H/C Type Handle
- \* Dead Lock
- \* Cylinder lock
- \* Hinge
- \* Fastener

## 4. Fire Door Maintenance Work

## 5. Annual Maintenance Contract for Fire Doors

## 6. Dock Leveler

## COLOR SHADE

RAL 1013



RAL 9001



RAL 9002



RAL 9003



RAL 9006



RAL 7042



RAL 7044



RAL 8014



RAL 8017



RAL 8024



# FIRE RATED DOORS

## METAL DOOR

Field	Specification
Rating	60/120 minutes
Stability	120 minutes
Integrity	120 minutes
Insulation	20 minutes
Shutter Thickness	46mm
Frame Section	143mm x 50mm & 100mm x 50mm
Frame Sheet	1.2mm/1.6mm
Shutter Sheet	0.8mm/1mm/1.2mm
Infill	Rockwool/Honeycomb/Lead Sheet
Test Lab	CBRI/NABL/GQMC
Test Standard	IS 3614 Part 2, BS 476 Part 20 and 22
Finish	Powder Coated/Stainless Steel



## WOODEN DOOR

Field	Specification
Criteria	Fully Insulated
Rating	60/120 minutes
Shutter Thickness	42/46/55mm
Infill	Rockwool & Calcium Silicate Board/Rubber Sheet/Leaf Sheet
Type of Wood	Hardwood Meranti/Teakwood
Seal	Intumescent Seal/Automatic Bottom Seal
Finish	Laminate/Veneer/Commercial Ply
Test Lab	CBRI/NABL/GQMC
Test Standard	IS 3614 Part2, BS 476 Part 20 and 22



## GLAZED DOOR

Field	Specification
Rating	120 minutes
Stability	120 minutes
Integrity	120 minutes
Insulation	20 minutes
Shutter Thickness	50mm
Frame Section	143mm x 50mm & 60mm x 50mm
Frame Sheet	1.6mm
Shutter Sheet	1.6mm
Infill	Rockwool
Test Lab	CBRI/NABL/GQMC/EFFECTIS, FRANCE
Test Standard	IS 3614 Part 2, BS 476 Part 20 and 22/EN1363-1: 2012, EN1363-2: 1999 and EN 1634-1: 2014
Finish	Powder Coated/Stainless Steel



## FHC DOOR

Field	Specification
Frame Section	10mm x 50mm
	1.6mm
Shutter Sheet Thickness	1.6mm
	Single Sheet
Finish	Powder Coated (Red) Stainless Steel
	4mm Float Glass with rubber gasket



# DOOR HARDWARE

Vision Panel

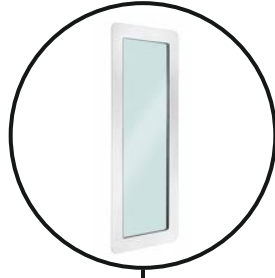

Flush/Tower Bolt



Door Closer



External Trim

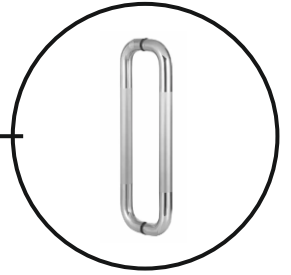

D Type Handle



Panic Exit Device



Mortise Dead Lock

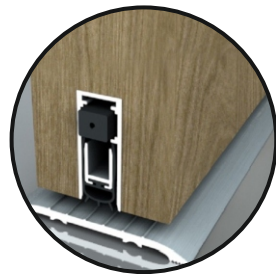

Auto Drop Seal



Kick Plate

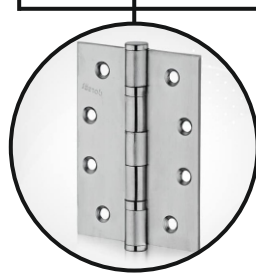

Ball Bearing Hinges

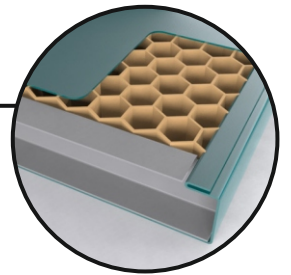

Door Infill



# DOOR HANDING

## Single Leaf

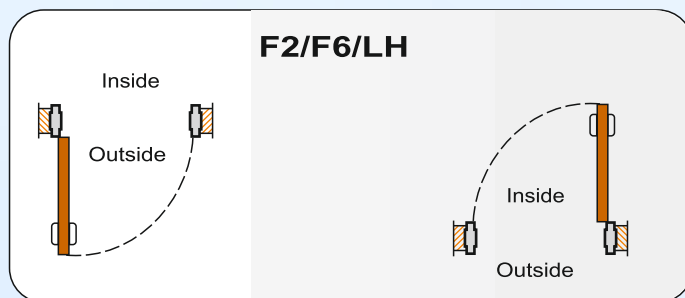
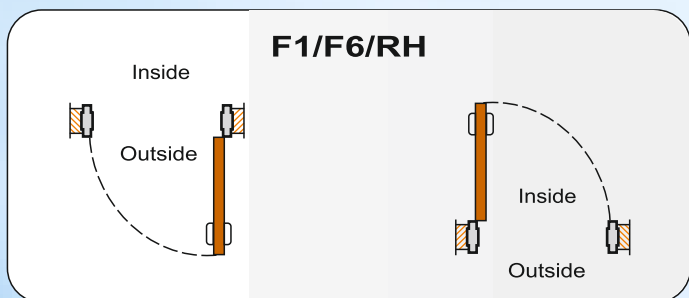

## Double Leaf

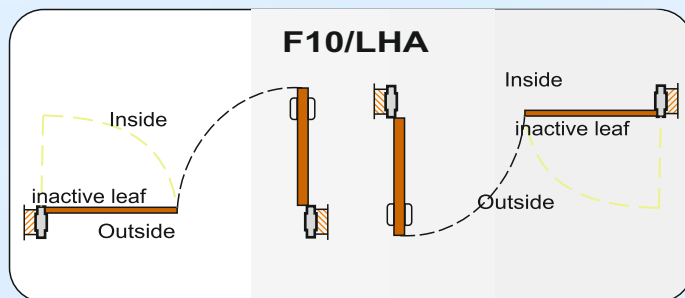
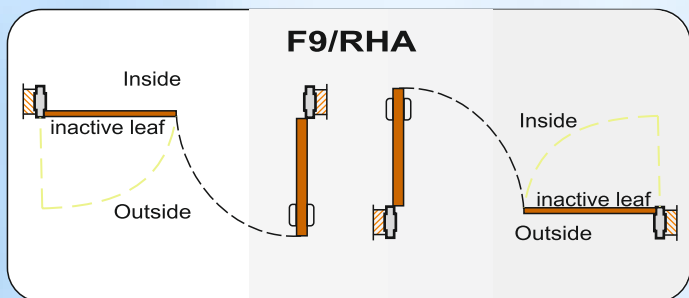
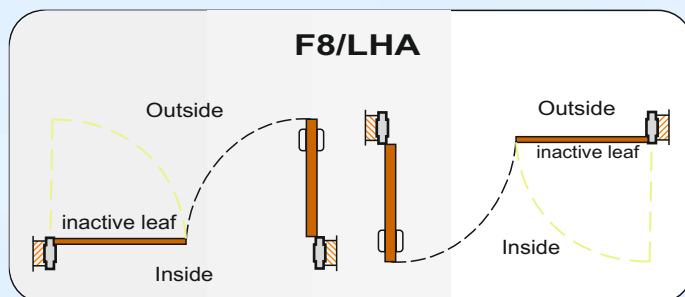
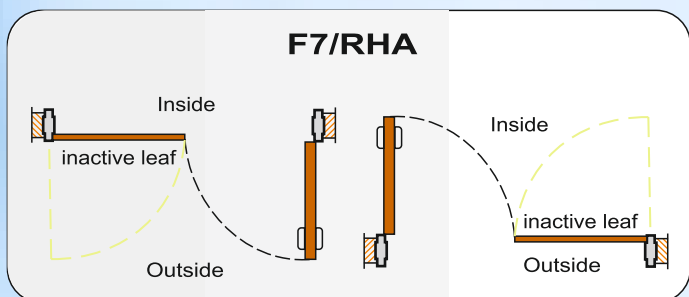

## Other Details

### INNER FILLING

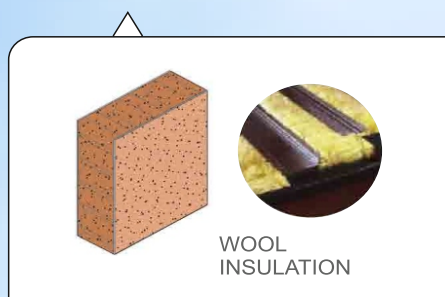

### FRAME SECTION

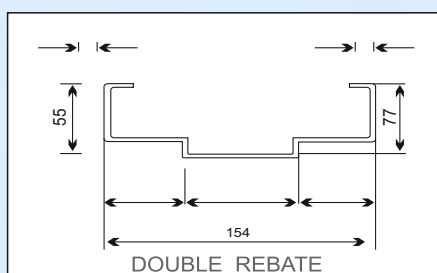

### ANCHOR COVER

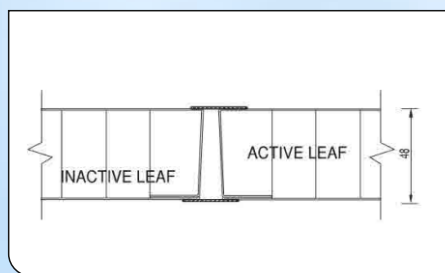
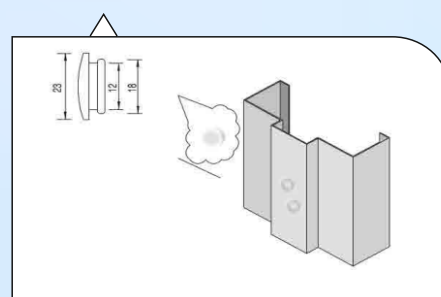

ASTRAGEL DETAIL

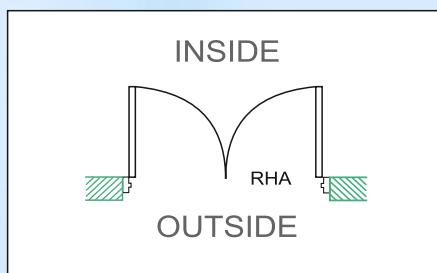

DOOR HANDING

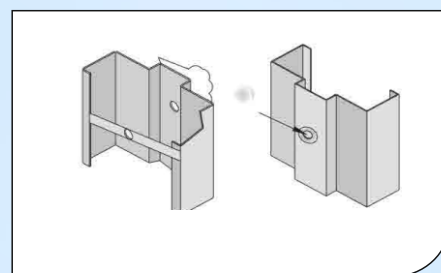

ANCHOR TYPE



# Associated Partner



# Our Client

